



## 60mm High Pressure Tinplate Can Top Cone For Aerosol Can / Spray Can

### Basic Information

- Place of Origin: China
- Minimum Order Quantity: negotiable
- Packaging Details: Paper Sleeve & Stretch Film & Pallet/ Carton
- Delivery Time: 20-45 Days



### Product Specification

- Product Type: Cone
- Application: Industrial And Household Use
- Material: Tinplate
- Deformation Pressure:  $\geq 1.8\text{MPa}$
- Usage: Aerosol Can Packaging
- Spray Pattern: Cone
- Compatibility: Compatible With Most Aerosol Products
- Highlight: **high pressure tinplate can top,  
60mm cone for aerosol can,  
60mm cone for spray can**

## Product Description

### 207.5#(60mm) High Pressure Top Aerosol Cone. White and Clear Tin Lid

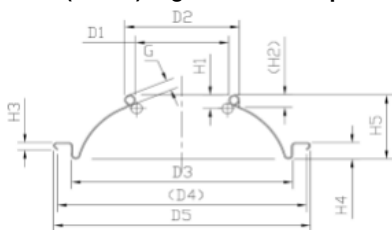

Flange diameter (D5)  $69.90 \pm 0.25\text{mm}$   
 Inner diameter of flange (D4)  $67.80 \pm 0.25\text{mm}$   
 Flange height (H3)  $2.45 \pm 0.15\text{mm}$   
 Buried depth (H4)  $5.10 \pm 0.10\text{mm}$   
 Total height (H5)  $18.50 \pm 0.15\text{mm}$   
 Contact height (H1)  $4.00 \pm 0.10\text{mm}$   
 Fit diameter (D3)  $60.20 \pm 0.20\text{mm}$   
 Outer diameter of tank mouth (D2)  $31.20 \pm 0.10\text{mm}$   
 Inside diameter of tank mouth (D1)  $25.40 \pm 0.10\text{mm}$   
 Dry glue quantity 70-90mg  
 Deformation pressure  $\geq 1.8\text{MPa}$   
 Burst pressure  $\geq$  high pressure  $2.1\text{MPa}$   
 Indenter fits well with the company's indenter  
 Sheet thickness 0.4  
 Iron hardness T4BA/T3CA

Q:Can you send samples?

A:Of course, we can send samples to all parts of the world, our samples are free, but customers need to bear the courier costs.

Q:What product information do I need to provide?

A:You need to provide the purchased specifications (technical instructions and specification drawings are in our product description) coating and quantity.

Q:What are the shipping ports?

A:We ship from Tianjin Port, or according to your designated port.

Q:About product prices?

A:Prices vary from period to period due to cyclical changes in the price of raw materials. As we are the manufacturer, we will provide an affordable and satisfactory price.

Q: How long does your delivery time take?

A:In general, our delivery time is within 20-45 days, and may be delayed if the demand is extremely large or special circumstances occur.

Q:Can I go to your factory to visit?

A:Of course, we welcome customers from all over the world to visit our factory.



**Tianjin Jiayi Haotian Industrial Co., Ltd**



+86 15522765700



caivee@jiayi-packaging.com



jiayi-packaging.com

Dongxing Road, Beihuan Industrial Park, Jinghai Town, Jinghai District, Tianjin, China